

PERMIT
 CITY OF NAPOLEON, OHIO - BUILDING DEPARTMENT
 255 West Riverview Avenue, Napoleon, Ohio 43545 - (419) 592-4010

Permit No. 3157 Issued 4-6-94
 Job Location 1060 Chesterfield
 Lot 15 Twin Oaks
 Issued by Brent N. Damman
 Owner Daryl Clayton
 Address Holiday Inn Napoleon
 Agent Keith Buehrer 592-3626
 Address 1227 Dodd Street 592-0825
 Use Type - Residential X
 Other - Describe _____
 No. Dwelling Units _____
 New X Replacement _____
 Add'n. Alter Remodel _____
 Mixed Occupancy _____
 Change of Occupancy _____
 Estimated Cost \$ 184,000

FEES	BASE	PLUS	TOTAL
<input type="checkbox"/> Building	\$ 9.00	\$ 300.00	\$ 309.00
<input type="checkbox"/> Electrical	\$ 15.00	\$ 90.00	\$ 105.00
<input type="checkbox"/> Plumbing	\$ 9.00	\$ 54.00	\$ 63.00
<input type="checkbox"/> Mechanical	\$ 18.00	\$ 12.00	\$ 30.00
<input type="checkbox"/> Demolition	\$	\$	\$
<input type="checkbox"/> Zoning	\$	\$	\$
<input type="checkbox"/> Sign	\$	\$	\$
<input type="checkbox"/> Water Tap	\$ 650.00	\$	\$ 650.00
<input type="checkbox"/> Sew. Insp.	\$	\$	\$
<input type="checkbox"/> Sewer Tap	\$ 60.00	\$ 274.15	\$ 334.15
<input type="checkbox"/> Temp. Water	\$ 5.00	\$	\$ 5.00
<input type="checkbox"/> Temp. Elec.	\$ 10.00	\$	\$ 10.00
TOTAL FEES.....			\$ 1506.15
LESS FEES PAID.....			\$
BALANCE DUE.....			\$ 1506.15

ZONING INFORMATION

district	lot dimensions	area	front yd	side yd	rear yd
5	150 X 150	22,522.5	40	15	20
max hgt	no pkg spaces	no ldg spaces	max cover	petition or appeal req'd	date appr
30'	2		30%		

WORK INFORMATION

Size: Length _____ Width _____ Stories _____ Ground Floor Area _____
 Height _____ Building Volume (for Demo. Permit) _____
 Electrical: _____
 Plumbing: _____
 Mechanical: _____
 Additional Information: _____

PAID
 MAY 02 1994
 CITY OF NAPOLEON

Date Mar 28-94 Applicant Signature Keith Buehrer

INSPECTION RECORD

	UNDERGROUND			ROUGH-IN					FINAL			
	Type	Date	By	Type	Date	By	Type	Date	By	Type	Date	By
PLUMBING	Building Drains			Drainage, Waste & Vent Piping	6/9	BD	Indirect Waste			Drainage, Waste & Vent Piping	8/18/99	Reg
	Water Piping									Backflow Prevention		
	Building Sewer			Water Piping	6/9	BD	Condensate Lines			Water Heater	8/18/99	Reg
	Sewer Connection									FINAL APPROVAL		
MECHANICAL	Refrigerant Piping			Refrigerant Piping			Chimney(s)			Grease Exhaust System		
				Duct Furnace(s)			Fire Dampers			Air Cond. Unit(s)		
	Ducts/Plenums			Ducts/Plenums	6/3	BD	<input type="checkbox"/> Radiant Htr(s) <input type="checkbox"/> Unit Htr(s)			Refrigeration Equipment		
				Duct Insulation	6/3	BD	Pool Heater			Furnace(s)	8/18/99	Reg
				Combustion Products Vents			Ventilation <input type="checkbox"/> Supply <input type="checkbox"/> Exhst.			FINAL APPROVAL		
ELECTRICAL	Conduits & or Cable			Conduits/Cable	6/3	BD	<input type="checkbox"/> Range <input type="checkbox"/> Dryer			Temp Service Temp Lighting		
	Grounding & or Bonding			Rough Wiring	6/3	BD	<input type="checkbox"/> Generator(s) <input type="checkbox"/> Motors			Fixtures Lampholders		
	Floor Ducts Raceways			Service Panel Switchboard	6/3	BD	<input type="checkbox"/> Water Htr <input type="checkbox"/> Welder			Signs		
	Service Conduit			Busways Ducts			<input type="checkbox"/> Heaters <input type="checkbox"/> Heat Cable			Electric Mtr. Clearance	6/9	BD
	Temporary Power Pole			Subpanels			<input type="checkbox"/> Duct Htr(s) <input type="checkbox"/> Furnace(s)			FINAL APPROVAL		
BUILDING	Location, Set-backs, Esmt(s)	4/3	BD	Exterior Wall Construction			Roof Covering Roof Drainage	6/3	BD	Smoke Detector *	8/18/99	Reg
	Excavation			offset venting	6/3	BD	Exterior Lath			Demolition (sewer cap)		
	Footings & Reinforcing	4/3	BD				<input type="checkbox"/> Interior Lath <input type="checkbox"/> Wallboard					
	Floor Slab			Interior Wall Construction			Fire Wall(s)			Building or Structure	8/18/99	Reg
	Foundation Walls	4/3	BD	Columns & Supports			Fireplace Chimney					
	Sub-soil Drain			Crawl Space <input checked="" type="checkbox"/> Vent <input checked="" type="checkbox"/> Access			Attic <input type="checkbox"/> Vent <input checked="" type="checkbox"/> Access	6/3	BD			
	Piles			Floor System(s)	5/4	BD				FINAL APPROVAL BLDG. DEPT.	8/18/99	Reg
	DRIVEWAY	7/21	Reg	Roof System			Special Insp Reports Rec'd			Certificate of Occupancy Issued	7/30	BD
ADDITIONAL	INSPECTIONS, CORRECTIONS, ETC.					INSPECTIONS, CORRECTIONS, ETC.						
	* REQUIRING AN ADDITIONAL											
	SMOKE DETECTOR AT TOP											
	OF STAIRS TO ROOMS OVER											
	GARAGE											

APPLICATION FOR

Residential, Building, Electrical, Plumbing, Mechanical, and Demolition Permit
 FROM - The City of Napoleon, Ohio, Building Department
 255 West Riverview Avenue; P.O. Box 151; Napoleon, Ohio 43545 - Telephone (419) 592-4010

218
3
54

ENTRY NO. _____

PERMIT NO. 3157 ISSUED 4-6-94

JOB LOCATION 1060 CHESTERFIELD

LOT 15 Twin Oaks
 (Subdivision or Legal Description)

ISSUED BY BND
 (Building Official)

OWNER DARYL CLAYTON PHONE _____

ADDRESS Holiday Inn Napoleon

AGENT KEITH BUENGER PHONE 592-3626
592-0825

ADDRESS 1227 0000 ST

USE: Residential () Commercial () Industrial
 () Other _____

WORK: New () Addition () Replacement () Remodel

ESTIMATED COST = \$ 184000

	Base	Plus	Total
<input checked="" type="checkbox"/> Building	\$ <u>9.00</u>	\$ <u>300.00</u> <small>234.00 20.00 2.00</small>	\$ <u>309.00</u>
<input checked="" type="checkbox"/> Electrical	\$ <u>15.00</u>	\$ <u>90.00</u>	\$ <u>105.00</u>
<input checked="" type="checkbox"/> Plumbing	\$ <u>9.00</u>	\$ <u>54.00</u>	\$ <u>63.00</u>
<input checked="" type="checkbox"/> Mechanical	\$ <u>18.00</u>	\$ <u>12.00</u>	\$ <u>30.00</u>
() Demolition	\$ _____	\$ _____	\$ _____
() Zoning	\$ _____	\$ _____	\$ _____
() Sign	\$ _____	\$ _____	\$ _____
<input checked="" type="checkbox"/> Water Tap	\$ <u>650.00</u>	\$ _____	\$ <u>650.00</u>
<input checked="" type="checkbox"/> Sewer Tap	\$ <u>60.00</u>	\$ <u>274.15</u>	\$ <u>334.15</u>
<input checked="" type="checkbox"/> Temp Water	\$ <u>5.00</u>	\$ _____	\$ <u>5.00</u>
<input checked="" type="checkbox"/> Temp Elec.	\$ <u>10.00</u>	\$ _____	\$ <u>10.00</u>

Additional Plan Review: Structure _____ Hours _____
 Electric _____ Hours _____

TOTAL FEES \$ 1506.15
 Less Fees Paid \$ _____
 BALANCE DUE \$ 1506.15

ZONING INFORMATION

District	Lot Dimensions	Area	Front Yard	Side Yard	Rear Yard
<u>S</u>	<u>150x150</u>	<u>22,522.5</u>	<u>40</u>	<u>15</u>	<u>20</u>

Max Height	No. Pkg. Spaces	No. Ldg. Spaces	Max Cover	Petition or Appeal Required-Date
<u>30'</u>	<u>2</u>		<u>30%</u>	

WORK INFORMATION

Building: Ground Floor Area _____ sq. ft. Basement Floor Area _____ sq. ft.
 Garage Floor Area _____ sq. ft. 2nd Floor Area _____ sq. ft. Other _____ sq. ft.
 Size: Width _____ Length _____ Stories _____ Height _____
 Building Volume (for Demolition Permit) _____ cubic feet
 Description of Work: Build new house home

ELECTRICAL: Contractor _____ Phone _____

Address _____ ESTIMATED COST = \$ _____

Type of Work: (X)New ()Service Change ()Rewiring ()Add'l Wiring TEMPORARY ELEC. REQUIRED - ()Yes ()No

Size of Service 200 Underground _____ Overhead _____ Number of New Circuits 30

Description of Work: _____

PLUMBING: Contractor _____ Phone _____

Address _____ ESTIMATED COST = \$ _____

WATER TAP REQUIRED - ()Yes ()No Size _____ Type of Pipe _____ Water Dist. Pipe _____

SANITARY SEWER TAP REQUIRED - ()Yes ()No Size _____ Type of Pipe _____ Dr. Waste Vt. Pipe _____

STREET SEWER TAP REQUIRED - ()Yes ()No Type of Pipe _____ STREET TO BE OPENED - ()Yes ()No

Main Building Drain Size = _____ Main Vent Pipe Size = _____

LIST NUMBER OF PLUMBING FIXTURES BELOW:

Water Closets = 4 Bathtubs = 2 Showers = 2 Lavatories = 6 Kitchen Sinks = 1 Disposal = 1

Clothes Washer = 1 Floor Drains = _____ Dishwasher = 1 Other L.T. Total = 18

Description of Work: _____

MECHANICAL: Contractor _____ Phone _____

Address _____ ESTIMATED COST = \$ _____

HEATING SYSTEM - ()Forced Air ()Gravity ()Hot Water ()Steam ()Unit Heaters ()Radiant ()Baseboard

TYPE OF FUEL - ()Electric ()Natural Gas ()Propane ()Wood ()Coal ()Solar ()Geothermal Other _____

NUMBER OF HEAT ZONES = _____ HOT WATER - ()One (1) Pipe ()Two (2) Pipes ()Series Loop

ELECTRIC HEAT - Number of Circuits _____ Number of Furnaces _____ Number of Hot Air Runs _____

Number of Hot Water Radiators _____ Total Heat Loss _____ Rated Capacity of Furnace/Boiler _____

LOCATION OF HEATING UNITS - ()Crawl Space ()Floor Level ()Attic ()Suspended ()Roof ()Outside

Description of Work: _____

DRAWINGS REQUIRED: All applications must be accompanied by two (2) complete sets of Drawings including Site Plans, Foundation Plans, Floor Plans, Structural Framing Plans, Exterior Elevations, Section and Details, Stair Details, Electrical Layout, Plumbing Isometric, Heating Layout, etc. All Plans shall be drawn to scale, show all existing structure on the Site Plans, and show electric panel and furnace locations.

READ AND SIGN BELOW: The undersigned hereby makes application for a Permit for all work described herein and agrees to complete the work in strict accordance with all applicable provisions of the current edition of the C.A.B.O. Building Code, the Napoleon Building and Zoning Codes, the Napoleon Engineering Department Rules and Regulations, Standard Specifications and other pertinent sections of the Napoleon Code of Ordinances.

Signature of Applicant Keith Beebe Date 3-28-94

WATER TAPPING PERMIT

issued by

The Napoleon Water Distribution Department
255 West Riverview Ave. Napoleon, Ohio 43545 Ph. 592-4010

Permit No. W- 0199 Issued 12 Apr 94 Received of _____ (\$ _____) .00

(Charge for tapping permit to supply water service to) Lot No. 15 Sub Div. Twin Oaks

Street No. 1060 Tap Size 1" Cost \$ 650⁰⁰ Plumber Keith Buehrer

Date completed _____ Approved by _____
water distribution dept. _____ finance director _____

Name _____ Size of tap 1" Date 4-19-94 Street and No. 1060 Chesterfield

Old Tap No. _____ New Tap No. 9419 Size and Kind of Main 8" C-900

Location of Main 6' North of North curb Depth of Main 5'

Distance from Hydrant/Valve 146' E. of Hyd. #405 Distance to Curb Stop from Corp. 48'

COMPLETED

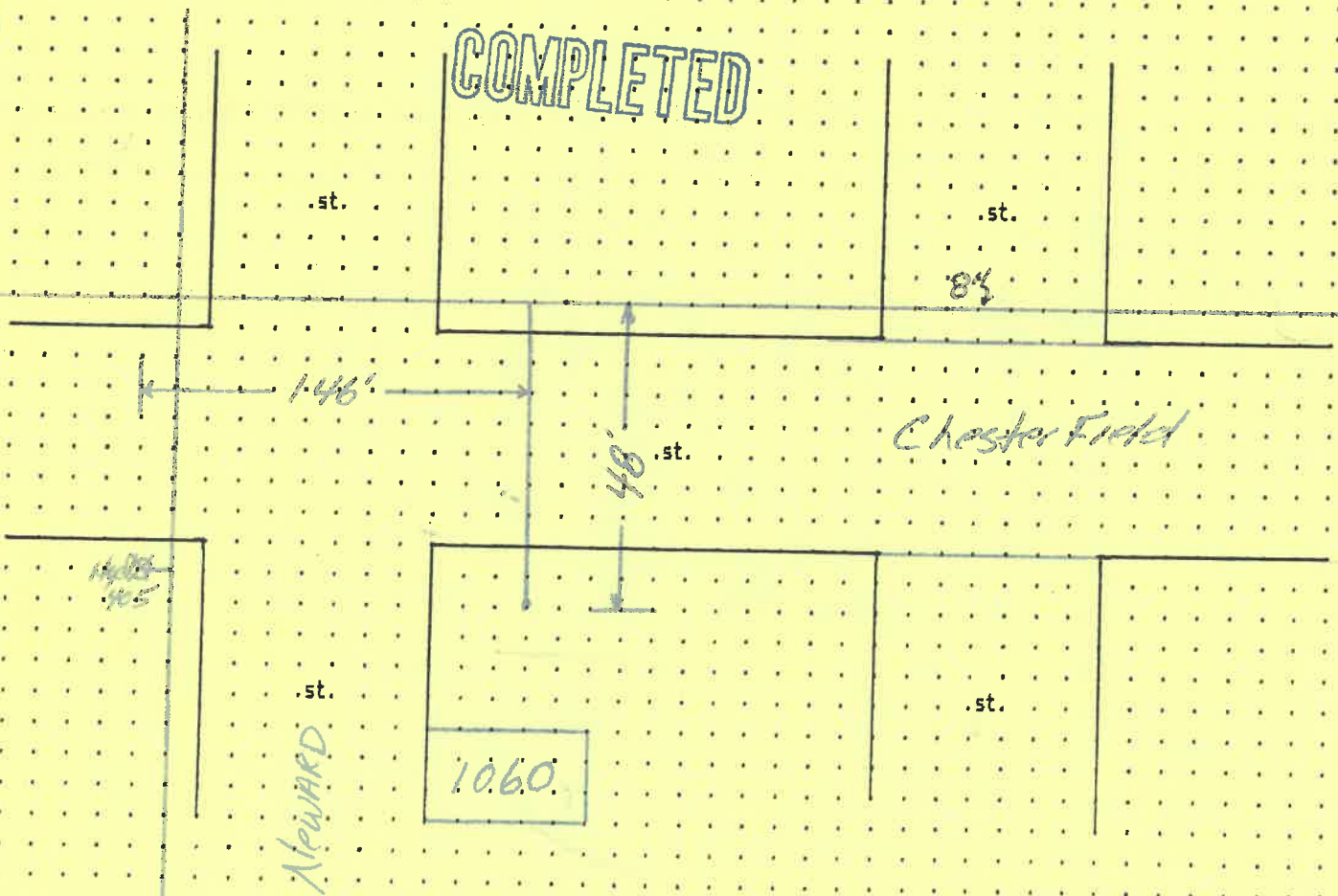

↑
N

4-8-94
Burkholder
Tom + Roger Mitta
1060 Chesterfield

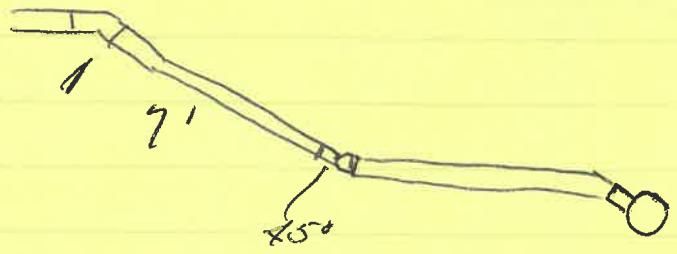
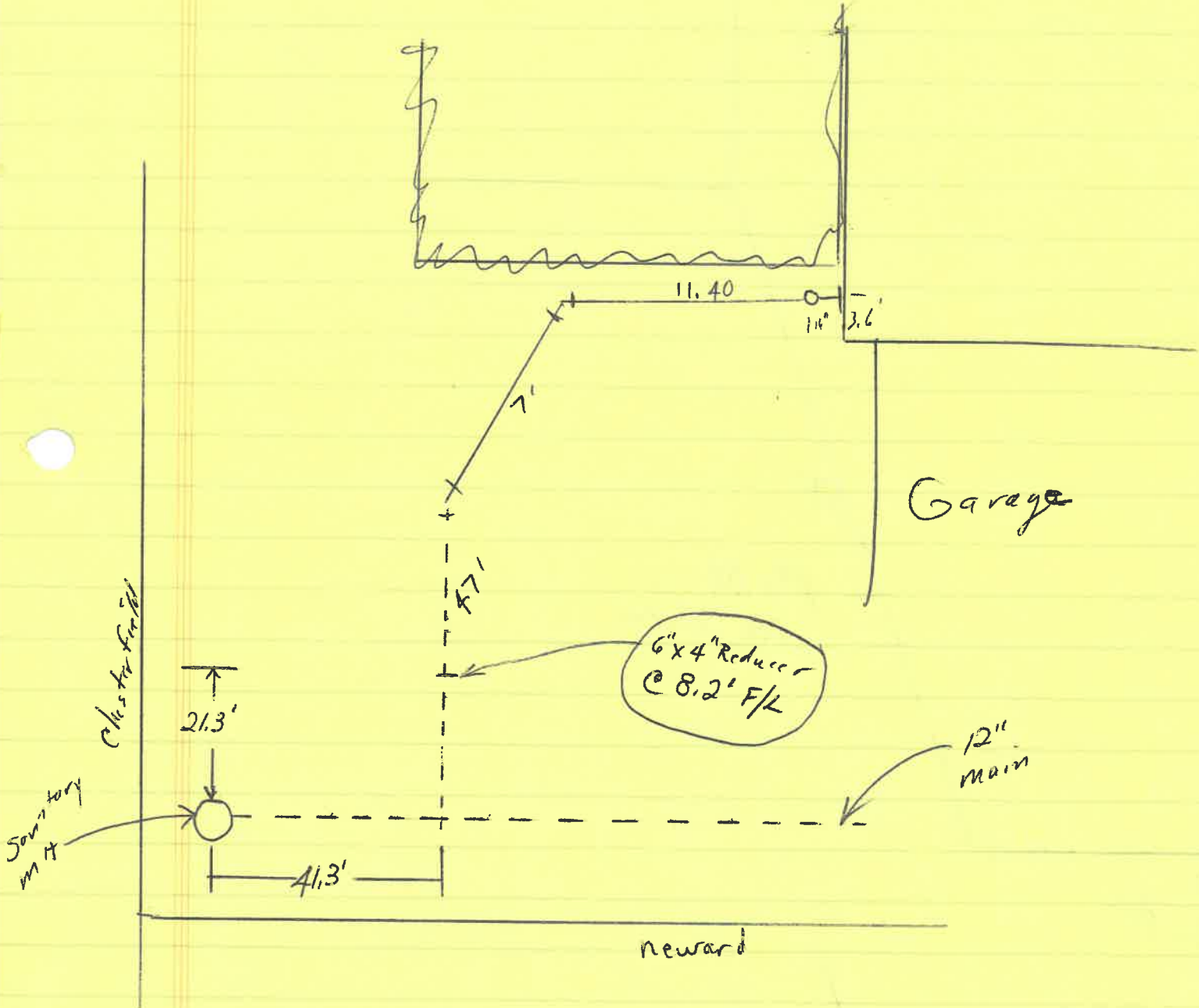

~~Handwritten scribble~~

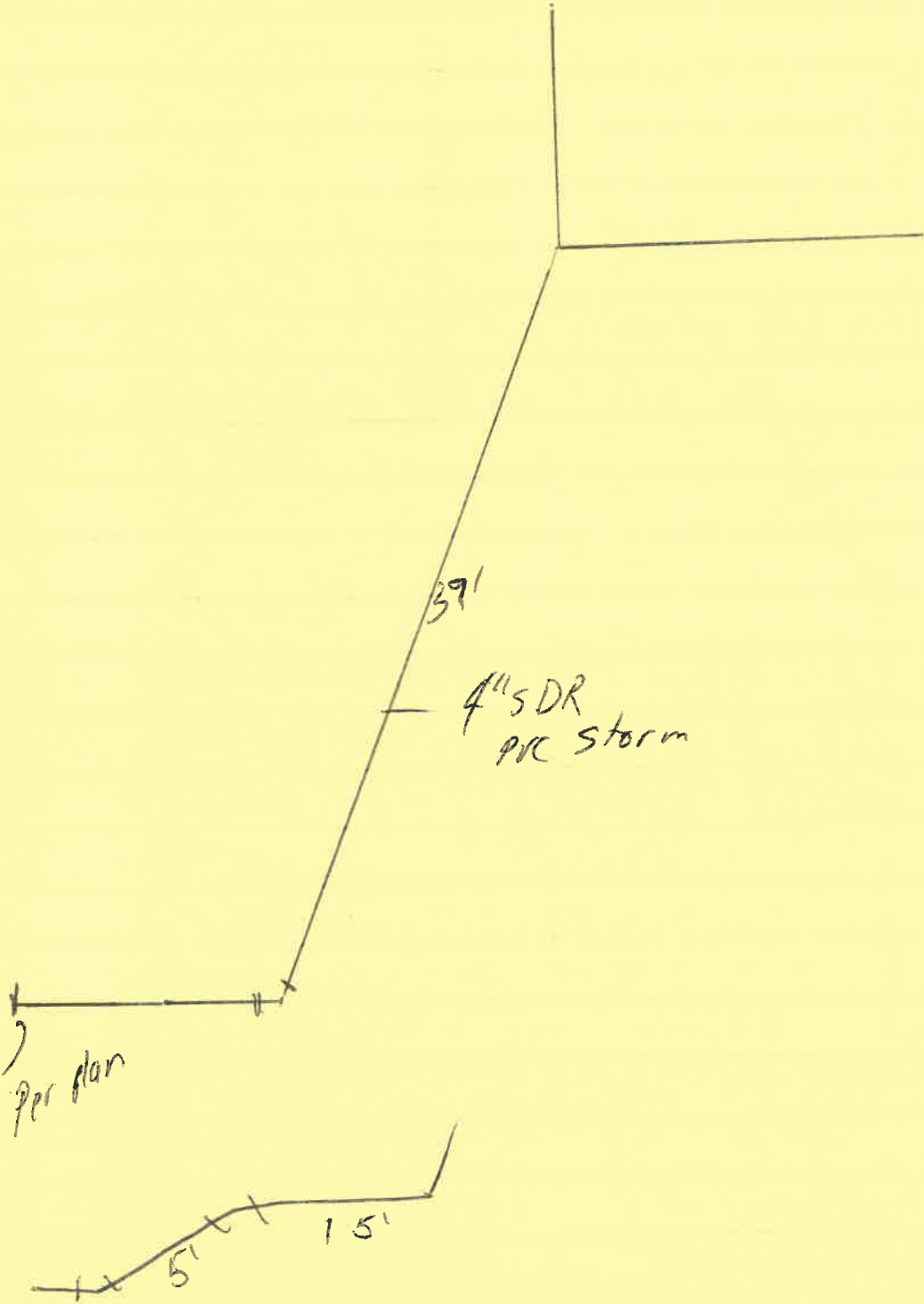

~~Plan~~

